

REMOVAL STEPS (Continued)

- >>D<< 12. TIMING BELT TENSIONER ARM
>>D<< 13. TIMING BELT TENSIONER ADJUSTER

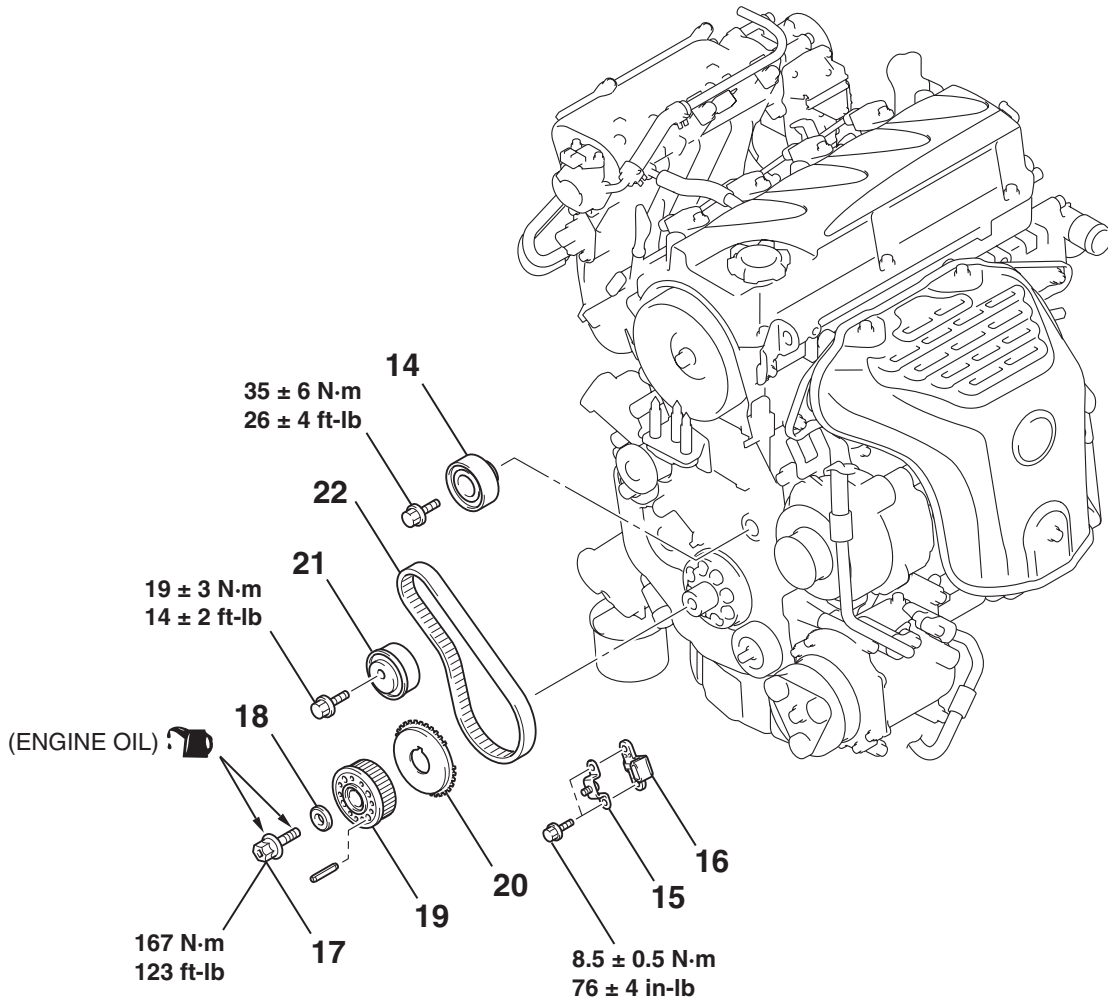

REMOVAL STEPS

14. TIMING BELT IDLER PULLEY
15. TIMING BELT LOWER COVER BRACKET
16. CRANKSHAFT POSITION SENSOR
<> >>C<< 17. CRANKSHAFT PULLEY CENTER BOLT
<> >>C<< 18. CRANKSHAFT PULLEY WASHER
<> >>C<< 19. CRANKSHAFT CAMSHAFT DRIVE SPROCKET

REMOVAL STEPS (Continued)

- >>C<< 20. CRANKSHAFT ANGLE SENSING BLADE
>>B<< • BALANCER TIMING BELT TENSION ADJUSTMENT (INSTALLATION ONLY)
>>A<< 21. BALANCER TIMING BELT TENSIONER
<<C>> >>A<< 22. BALANCER TIMING BELT

Required Special Tools:

- MB991367: Special Spanner
- MB991385: Pin
- MD998738: Adjusting Bolt
- MD998767: Tensioner Wrench