

## Injector YP725cc

Part Number #34016

### Basic Specifications

#### Electrical

- Impedance 12  $\Omega$
- Maximum power supply 16 V

#### Physical

- Operating temperature range -40 to 110  $^{\circ}\text{C}$
- System pressure maximum 8 bar
- Weight 25 g
- EV6 style connector
- Flow rate 715 cc/min @ 3 bar, 100% duty on VP C16 fuel at 52  $^{\circ}\text{C}$  (125  $^{\circ}\text{F}$ )
- 14 mm top O-Ring
- Fuel rail bore size 13.89 mm (0.547")

#### Compatibility

- All MoTeC ECUs

#### Accessories

- #34018 Adapter top 11mm for YP Injectors
- #34019 Adapter top 14mm for YP Injectors
- #34006 EV1 PNP Adapter Connector for YP Injectors

#### Dimensions [mm]

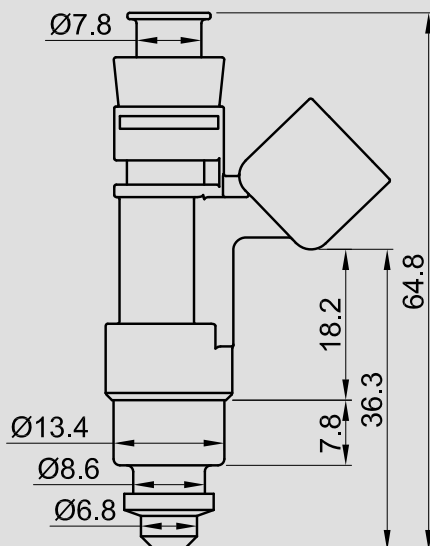

### Applications

The YP725cc injector is a high impedance, "saturated" injector. Suitable for most fuel injected engines.

### Features

- Excellent low pulse width response
- Good atomization
- Excellent consistency

### Wiring

#34015 Pin	ECU pin
Power	12V
Drive	Injector Output

Refer to the ECU User Manual for pin numbers.

**Note:** All MoTeC User Manuals are available from [www.motec.com/downloads](http://www.motec.com/downloads)

## Calibration

Procedure described for Version 3 software.  
Configuration in Version 2 software is similar.

- On the **Adjust** menu, click **General Setup** and then click **Fuel**.
- Click **Setup** and enter **Injector Current 0.0**.  
**Note:** This is not the actual injector current, but this setting disables the current control.
- Press **ESC** and click **Battery Comp.**
- Enter values according to the following table:

Injector Battery Compensation							
Fuel Pressure		Dead Time [ $\mu$ sec] (1000 $\mu$ sec = 1 ms)					Flow [cc/min]
[kPa]	[psi]	8 V	10 V	12 V	14 V	16 V	
276	40	1910	1320	1030	775	660	690
300	43.5	1975	1355	1040	795	670	715
310	45	2005	1365	1045	800	680	730
345	50	2095	1420	1065	830	700	770
379	55	2185	1465	1090	860	720	810
414	60	2270	1520	1115	895	745	850
448	65	2350	1575	1140	930	765	890
483	70	2440	1630	1175	970	790	925
517	75	2545	1685	1215	1010	815	960
552	80	2675	1740	1265	1045	850	990
586	85	2840	1790	1320	1075	885	1020
621	90	3035	1845	1375	1100	925	1050
655	95	3250	1900	1435	1125	960	1080
689	100	-	1965	1490	1155	995	1110
724	105	-	2040	1540	1185	1020	1140
758	110	-	2120	1580	1220	1040	1170
793	115	-	2219	1615	1260	1055	1200
827	120	-	2300	1650	1300	1070	1235

**Note:** Injector requires a minimum 10 V to run at 689 kPa (100 psi) and higher.