

Step3: Disconnect the crankshaft sensor by the fuel regulator so that you can crank the engine over so it won't start.

16-40

**ENGINE ELECTRICAL
IGNITION SYSTEM**

CRANKSHAFT POSITION SENSOR

REMOVAL AND INSTALLATION

M1183003500378

CAUTION

If the vehicle is equipped with the Brembo disc brake, during maintenance, take care not to contact the parts or tools to the caliper because the paint of caliper will be scratched.

Pre-removal and Post-installation Operation

- Timing Belt Removal and Installation (Refer to GROUP 11A, Timing Belt P.11A-50).
- Radiator Reserve Tank Assembly Removal and Installation (Refer to GROUP 14, Radiator P.14-22).

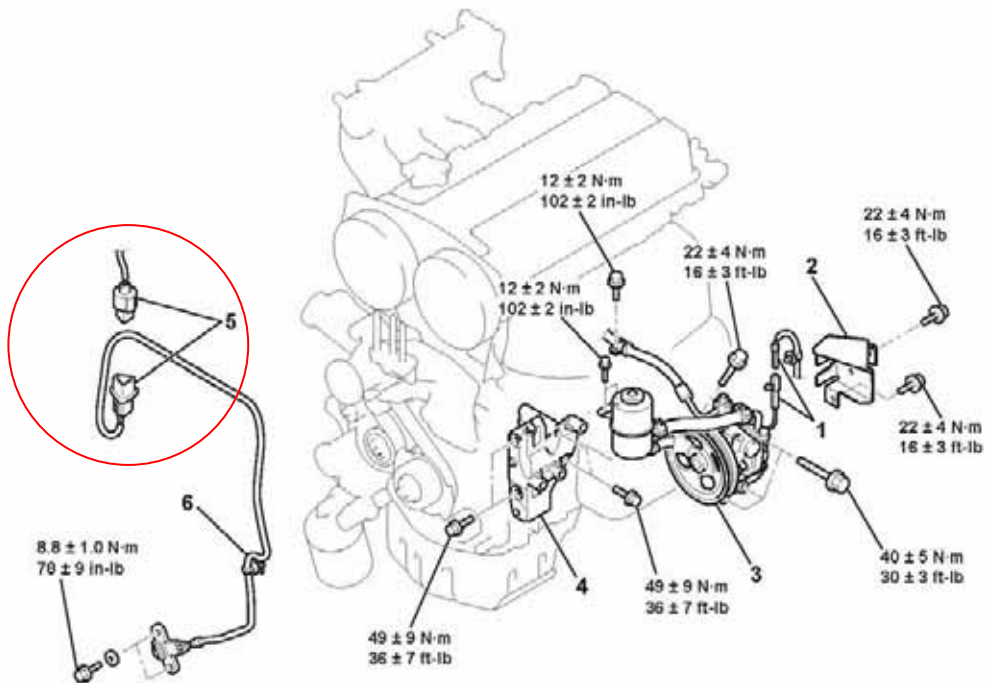

AC210409AB

REMOVAL STEPS

1. POWER STEERING PRESSURE SWITCH CONNECTOR
2. POWER STEERING OIL PUMP HEAT PROTECTOR
3. POWER STEERING OIL PUMP, BRACKET AND OIL RESERVOIR ASSEMBLY

REMOVAL STEPS (Continued)

4. POWER STEERING OIL PUMP BRACKET
5. CRANKSHAFT POSITION SENSOR CONNECTOR
6. CRANKSHAFT POSITION SENSOR

<<A>>

TSB Revision